

Expandable S

Mobile trailer solution



With HMK Bilcon's **Expandable S**, you get a solid trailer that is manufactured and thoroughly tested according to our high quality standards. We have designed the trailer based on our extensive industry knowledge and many years of experience in building customized solutions. In the development phase, emphasis has been placed on functionality and ease of use, and it only takes 20 minutes for a trained person to set up the trailer. The trailer is built in 63 mm glass fiber reinforced polyester panels, which form the outer and inner cladding manufactured according to the "sandwich" principle to achieve great strength and insulation.

Spacious and flexible

The trailer can be easily transported and set up anywhere. When setting up the trailer, the sides are easily extended by remote control obtaining an internal area of 52 m² in total, particularly suitable for teaching, seminars, presentations, and courses. The interior of the trailer is made according to your wishes and can include air-conditioning, underfloor heating, toilet facilities, networks, AV systems, and much more. We also offer installation of solar panels on the trailer to minimize power consumption and supply the trailer with power during parking.

BENEFITS

HIGH QUALITY

FAST SETUP

DELIVERY ON TIME

FLEXIBLE INTERIOR DESIGN

LONG LIFETIME

UP TO 3 YEARS WARRANTY

Expandable S

Mobile trailer solution

Dimensions

	Internal	External
Length		13.6 m
Width, transport		2.55 m
Width, set up	Up to 4.42 m	Up to 4.55 m
Total height, transport		4.00 m
Internal height	2.60 m	
Entrance height above ground	1.10 m	
Internal height extensions	Up to 2.25 m	
Extension dimensions		8m x 1 m
Total floor area	Up to 52 m ²	
Net weight (depending on equipment)		12,000-22,000 kg

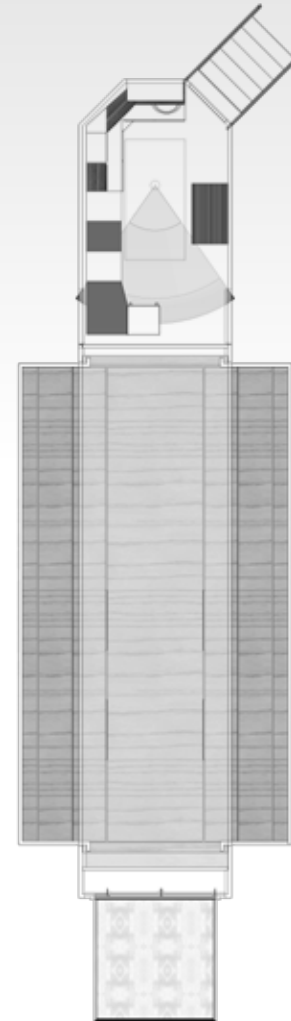

EQUIPMENT & OPTIONS

AIR-CONDITION

FLOOR HEATING

POWER GENERATOR

KITCHEN FACILITIES

TOILET FACILITIES

INTERNAL NETWORK

WARDROBE

PARTITIONS

WINDOWS

ADDITIONAL DOORS

A/V-SYSTEM

DESKS

LIFT

AND MUCH MORE